

Fire protection enclosure PRIOELEC ESL BIG-Line

Fire-resistance rating 90 minutes

Suitable for function preservation for up to 90 minutes



Large fire protection enclosure

PRIOELEC ESL BIG-Line



Suitable for function preservation for up to 90 minutes*

Available assembled or disassembled

Integrated ventilation system



- Cable cooling channel and optionally available rear panel



- Integrated fan unit with smoke detector



- Integrated mounting rails



- Bottom clearance, with removable front panel

Fire-resistant large enclosure for housing electrical safety systems required by building regulations. The enclosure can be supplied either in individual parts on a pallet or fully assembled.

The large enclosure is smoke-tight (fire from inside) and offers a fire resistance of 90 minutes.

Proof of functional integrity must be provided and documented in accordance with MLAR 5.2.2 c).

It must be ensured that the function of the electrotechnical installations is guaranteed in case of fire for the necessary duration of the functional integrity, unless there is a building authority certificate of usability for the functional integrity.



Fire-resistant
to achieve a fire resistance of 90 minutes



Smoke protection
Components have an elastic smoke protection seal



Non-combustible
Components including surface are tested and classified according to EN 13501-1



Surface insensitive
to all common household cleaning agents



Mark of conformity
Building materials/components and/or types of construction with a general building approval mark



German Institute for Standardisation
Tested according to German industrial standard



European standard
Tested according to harmonised European standard

Function

- Fire resistance 90 minutes, fire-resistant
- Suitable for function preservation for up to 90 minutes*

Construction

- Empty enclosure with high mechanical resistance
- Integrated ventilation system, consisting of fan and smoke detector, installed ready for connection (230 V AC), cold smoke-tight
- Stainless steel door hinges
- Door opens into the enclosure, approx. 180° opening angle
- 2-point door locking via swivelling lever with double-bit cylinder (exchangeable against house locking system)
- All-round fire protection seal, foams up automatically in case of fire
- Cable entry at top + bottom, for fret entry
- Cable cooling duct
- Fixing rail for mounting the unit support or mounting plate
- Anti-tilt protection of the enclosure through fastening straps at the top
- Integrated pedestal accessible from below, with removable front panel
- Available in assembled or disassembled version (the installation site must be suitable for the weight of the housing, among other things)
- Version available without fire dampers
- Version available with fire dampers

Material characteristic

- Non-combustible panel with surface coating, classified A2 - s1, d0: non-combustible
- Standard surface CPL
- Standard colour light grey, similar to RAL 7035

Scope of delivery

- Fire protection enclosure PRIOELEC ESL BIG-Line disassembled or fully assembled on pallet
- Cable cooling duct
- Fastening material

Options and accessories

- Rear wall for free installation
- Installation on site by PRIORIT
- Many PRIORIT surfaces possible

Fire damper BSK-FK90-100

- Smoke-tight when closed, thermal release via fusible link at 72°C
- Self-closing due to thermal release
- Fire protection tested according to DIN EN 1366-2
- Weight: 13.0 kg

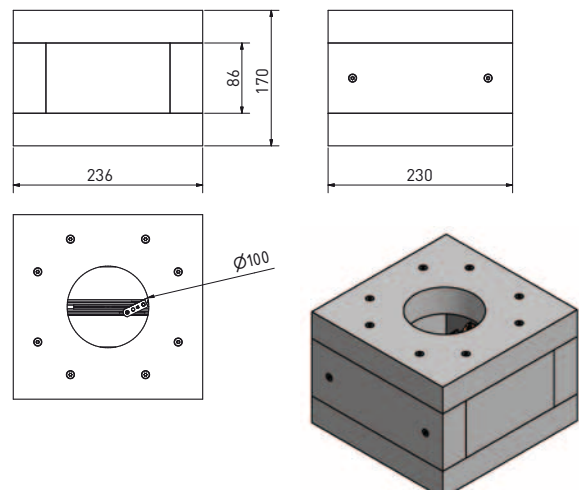

* Depending on the fixtures and their arrangement.

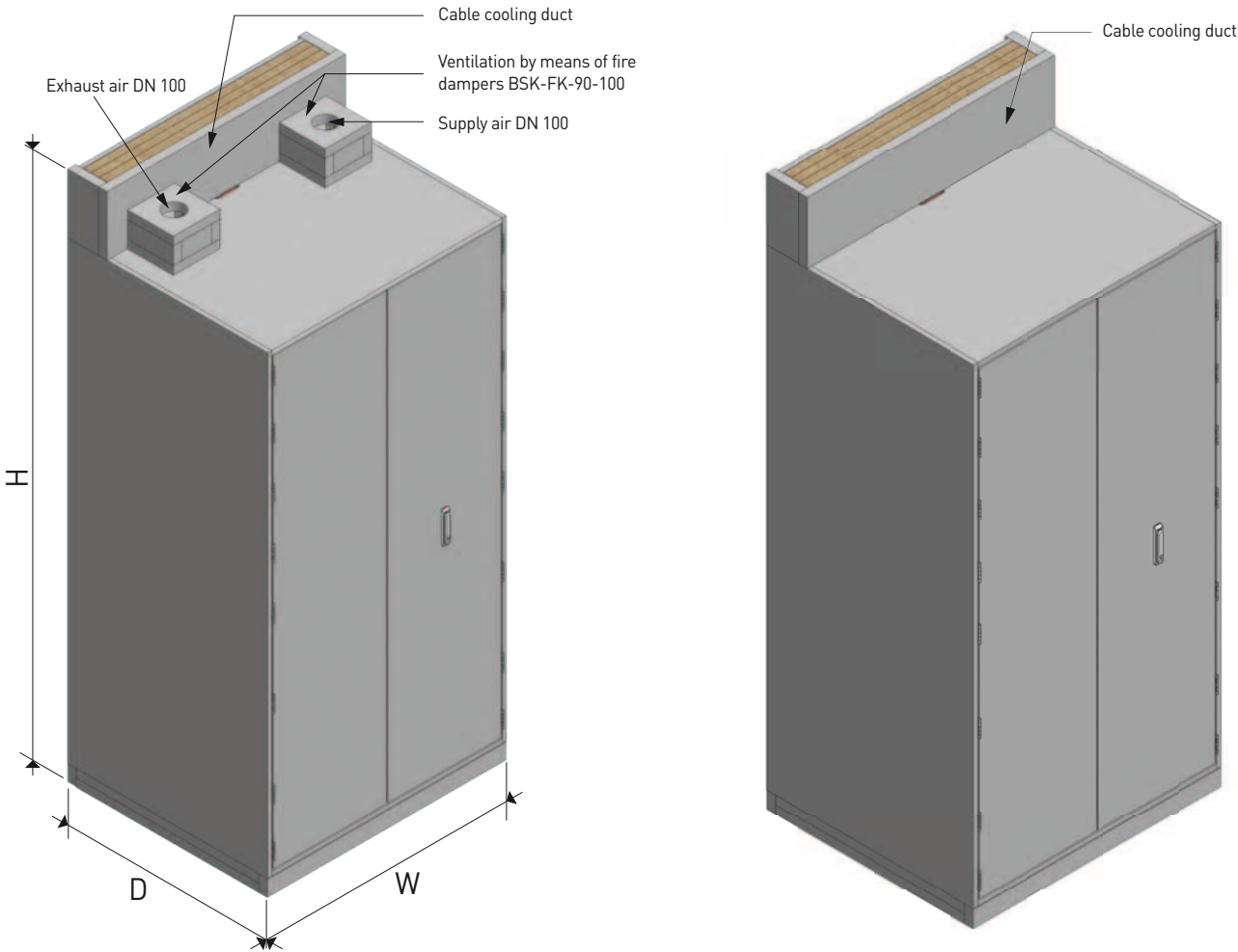

Large fire protection enclosure PRIOELEC ESL BIG-Line

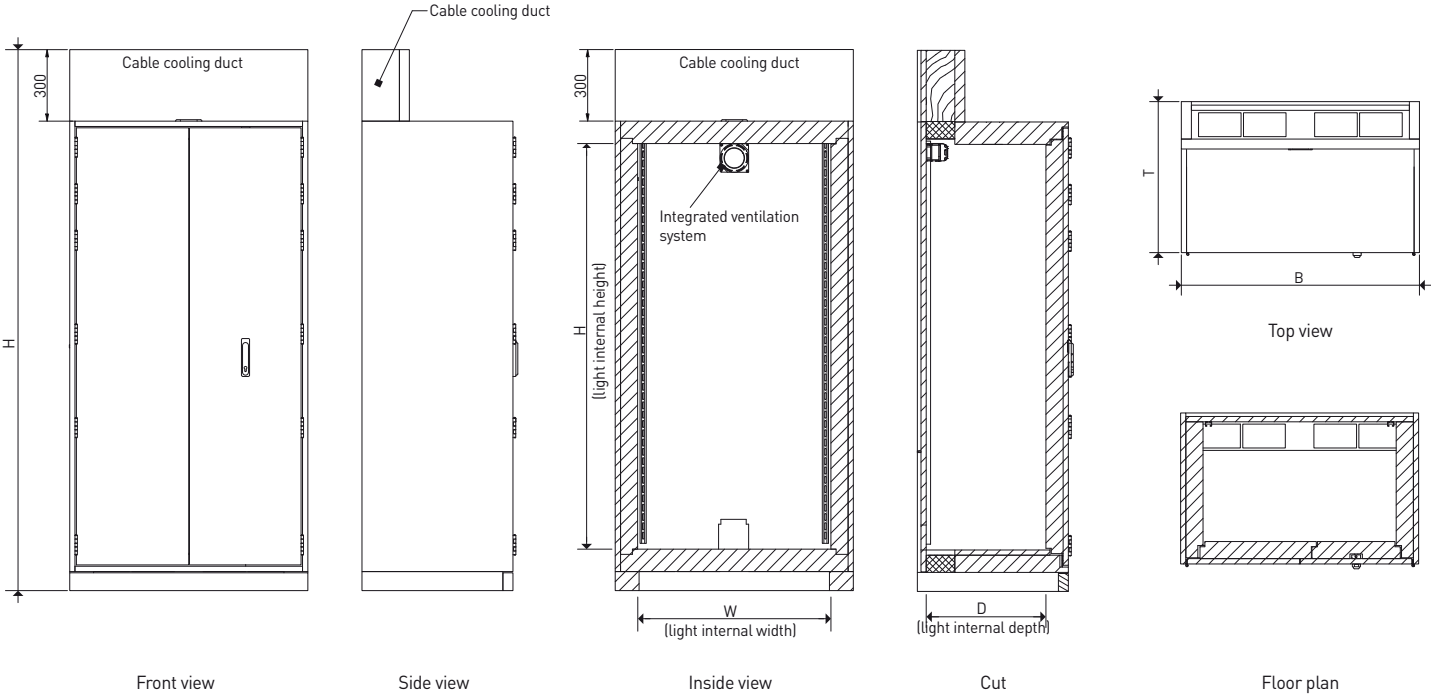

Large fire protection enclosure PRIOELEC ESL BIG-Line with fire-resistant supply/exhaust air system each NW 100 mm for connection to on-site fire-resistant fire protection duct system (ventilation system)

Large fire protection enclosure PRIOELEC ESL BIG-Line

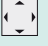

Art.	Code ¹	 H x W x D mm	 H x W x D mm	 kg	 P _{Vmax} = W	Description
Standard sizes 2-leaf						
ESL92.170.081.050	-x	2272 x 998 x 631	1700 x 810 x 500	550	250	
ESL92.170.081.065	-x	2272 x 998 x 781	1700 x 810 x 650	633	250	
ESL92.170.081.087	-x	2272 x 998 x 1009	1700 x 810 x 878	762	250	
ESL92.170.101.080	-x	2272 x 1198 x 931	1700 x 1010 x 800	808	250	
ESL92.200.081.050	-x	2572 x 998 x 631	2000 x 810 x 500	612	260	Disassembled ex works, self-assembly*
ESL92.200.081.065	-x	2572 x 998 x 781	2000 x 810 x 650	704	260	Disassembled ex works, self-assembly*
ESL92.200.101.080	-x	2572 x 1198 x 931	2000 x 1010 x 800	893	260	Disassembled ex works, self-assembly*
ESL92.211.101.087	-x	2683 x 1204 x 1009	2111 x 1016 x 878	980	280	Disassembled ex works, self-assembly

* Fully assembled ex works on request, as special transport may be necessary

Other sizes on request

You will find the text of the invitation to tender at www.priorit.de.

¹Code x: without = disassembled ex works, self-assembly
 -1 = disassembled ex works, self-assembly, with fire dampers BSK-FK90-100
 -M = fully assembled ex works
 -M1 = fully assembled ex works, with fire dampers BSK-FK90-100



Order example:

ESL92.170.101.080-M1 → Large fire protection enclosure ESL92; fully assembled ex works, with fire dampers BSK-FK90-100

P_{Vmax} Recommended approx. values for mounting and installation on a fire-resistant wall. A „derating“ of the electrical equipment must be taken into account. Compliance with the limit excess temperatures according to the valid DIN EN 61439-1 must be observed.



Power loss in normal operation at ΔT = 13 K (inside 35°C, outside 22°C), with integrated ventilation system.

Art.	Accessories	 H x W x D mm	 kg
ESL.RW-90-170-081	Two-part rear panel for free installation	2317 x 998 x 42	191
ESL.RW-90-170-101	Two-part rear panel for free installation	2317 x 1198 x 42	230
ESL.RW-90-200-081	Two-part rear panel for free installation	2617 x 998 x 42	216
ESL.RW-90-200-101	Two-part rear panel for free installation	2617 x 1198 x 42	260
ESL.RW-90-211-101	Two-part rear panel for free installation	2728 x 1204 x 42	271
EBR91:MONT	Installation of the ESL BIG-Line on site by PRIORIT		
VENT-24V	Additional ventilation set, consisting of fan 24V DC + aluminium flex tube (only in combination with BSK-FK90-100); without power supply unit.		
VENT-24V-NETZ	Power supply unit for additional ventilation set 24V 60 W; with top-hat rail		

Requirement: Function preservation

Possible solution using the example of a PRIOELEC ESL BIG-Line with integrated ventilation, with requirement of function preservation for 30 minutes

Possibility of verification:

1 Tested, approved fire protection empty enclosure

Temperature curve in the fire test, empty enclosure

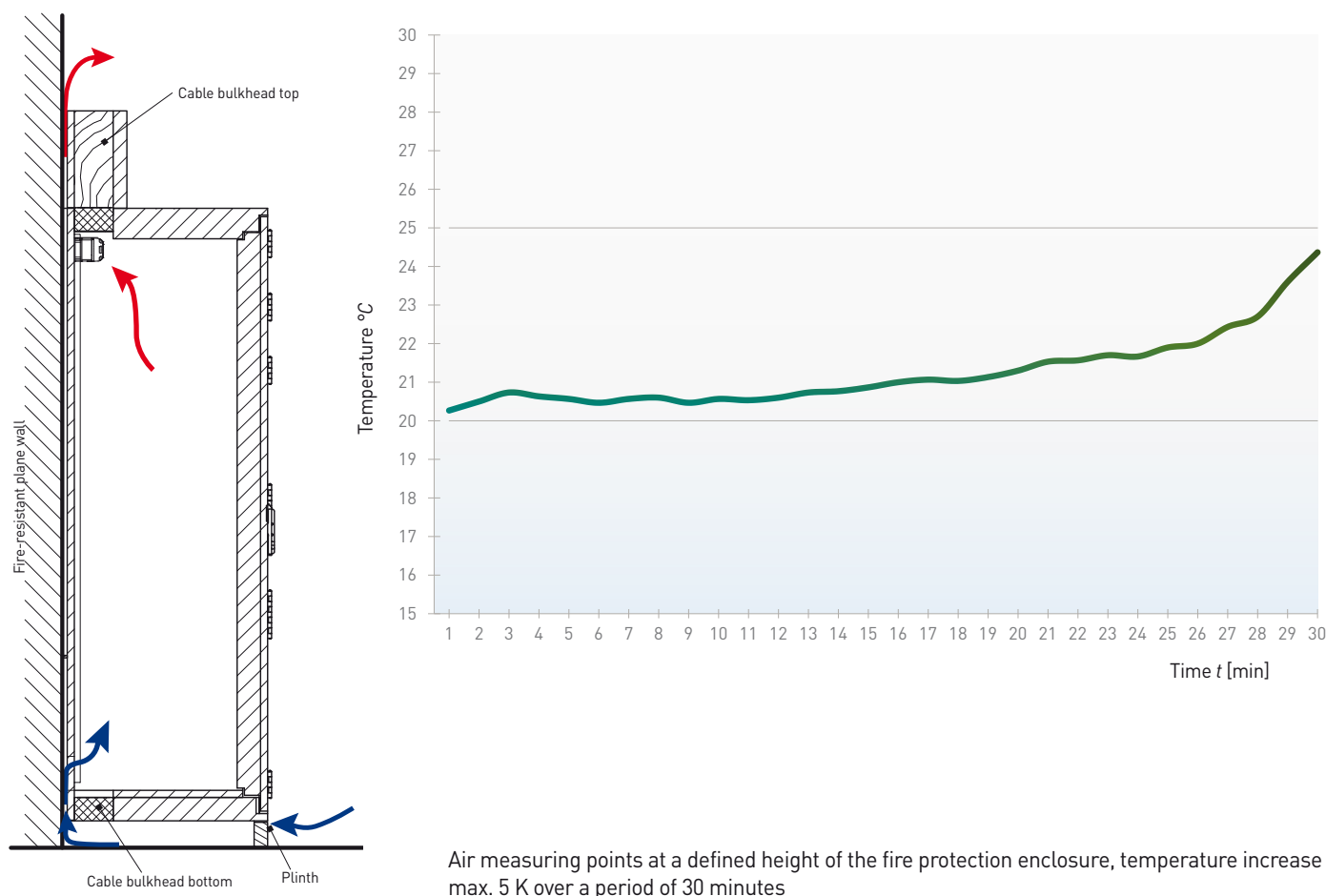

2 Documentation

Proof of functional integrity must be provided and documented (MLAR 5.2.2c).

One way of documenting the functional integrity of electrical systems - without the use of flame treatment - is to simulate a fire on a test bench.

Using a specially developed test bench, PRIORIT offers the possibility to document the functional integrity of electrical installations (MLAR 5.2.2 c).

Documentation

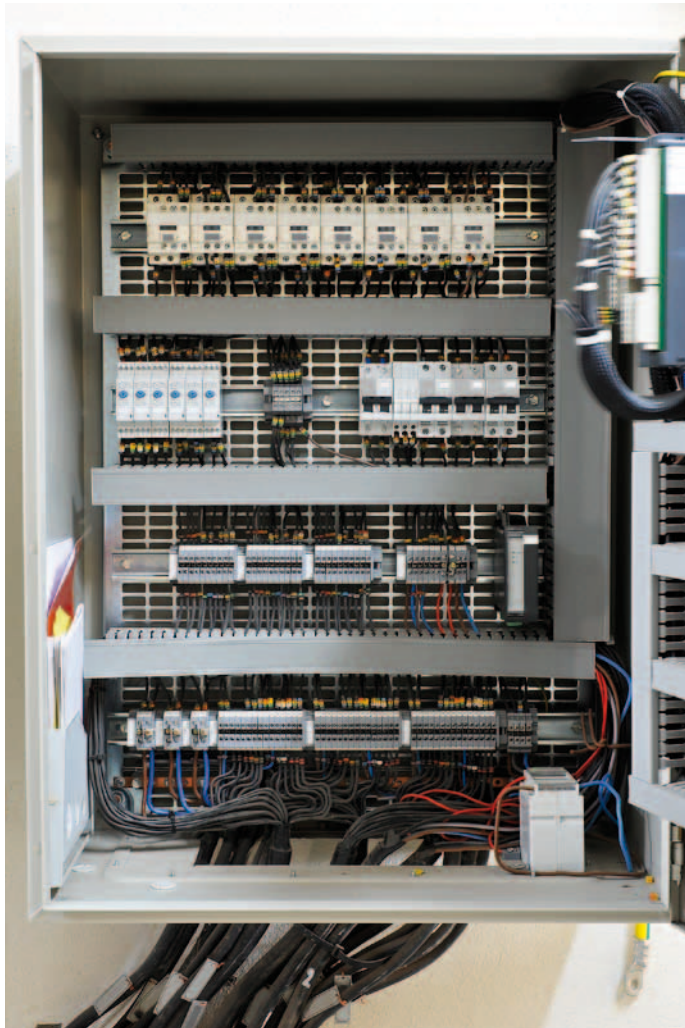

In this process, an electrical system is tested in full function, under the same environmental conditions that were measured in a fire protection empty enclosure within a fire test. The temperature and humidity readings are simulated over a period of 30 minutes (ETK) in this process.

The replication of the fire test values over time (temperature and humidity time curve) takes place in two identical chambers - the „reference chamber“ and the „test chamber“.

The result is a documentation as proof of the functionality of the electrical safety system in the fire protection empty enclosure, with proof of the equipment, consisting of:

- a. Verification of usability of the fire protection enclosures of PRIORIT AG,
- b. Assembly and fitting of the electrotechnical components by the manufacturer,
- c. Presentation of installer certificate.

The test simulation makes it possible to document the functionality of electrical components in the event of a fire by means of non-destructive testing.

As an alternative to a fire simulation on our test bench, we offer a planning aid for documenting functional integrity in conjunction with PRIORIT empty enclosures.

Manufactory and Safety

Our ISO 9001 certification provides safety and peace of mind. All development and production processes of PRIORIT fire protection products comply with internationally recognized regulations. You can be assured of that! That is a certainty!

PRIORIT AG
Technologiepark Hanau
Margarete-von-Wrangell-Straße 23
D-63457 Hanau-Wolfgang

Telefon: +49 6181 3640-0
Telefax: +49 6181 3640-210

info@priorit.de
www.priorit.de

