



PRIOROOM consisting of

- + PRIOWALL
- + PRIOCEIL
- + PRIODOOR FSA
- + Accessoire bulkhead
- + Accessoire ventilation

**Fire
Resistance
90 Min.**



**Smoke
Protection
min leakage**



**Material
+ Decor
A2 Class**



EN



SYSTEM 42

PRIOROOM

Fire Resistant Storage Room

Fire-resistant space of non-combustible A2 – s1, d0 building material for the construction of storage and service areas required by building regulations: theatre/props– sales areas/waste – escape and rescue routes/vending machines and others. With only 42 mm panel thickness, the room offers a space-saving alternative to conventional solid construction. Benefits: chemically highly stable, decorative internal and external surface, fast and clean to install, extensible, can be re-configured. The room is smoke-tight and provides 90 minutes fire resistance.

Function

- Fire resistance 90 minutes: fire-resistant
- Wall: EI 90 classification
- Ceiling: F 90/EI 90 a↔b
- T 90-RS classification of door(s)
- Door(s) are smoke-tight, tested for continuous operation



■ Edge guard in stainless steel



■ Triple latch lock



■ Hydraulic door closer

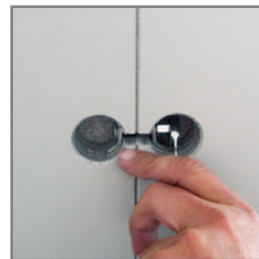

■ Can be built and converted quickly and cleanly

Construction

- Room with high mechanical resistance
- Fire protection through the formation of a separate fire compartment
- Modular design of prefabricated parts
- Overall height up to 3,670 mm, overall width up to 6,500 mm and unlimited depth
- Door height and width up to max. 2,500 mm
- Door(s) with 3D stainless steel bands, opening angle ca. 170°
- Door(s) with hydraulic door closer, triple locking system, prepared for single cylinder
- Fire-resistant vents K90 NW 100 mm, freely positionable within the wall elements
- Fire resistant cable bulkhead 125 mm diameter, 60% assignable, freely positionable within the wall elements
- Room can be equipped with lighting, ventilation, shelves and fire protection bulkheads

Material characteristic

- Building material with non-combustible surface coating on both sides, classification A2 – s1, d0
- Standard CPL surface
- Colour light grey, similar to RAL 7035, edges and bevels in different colour

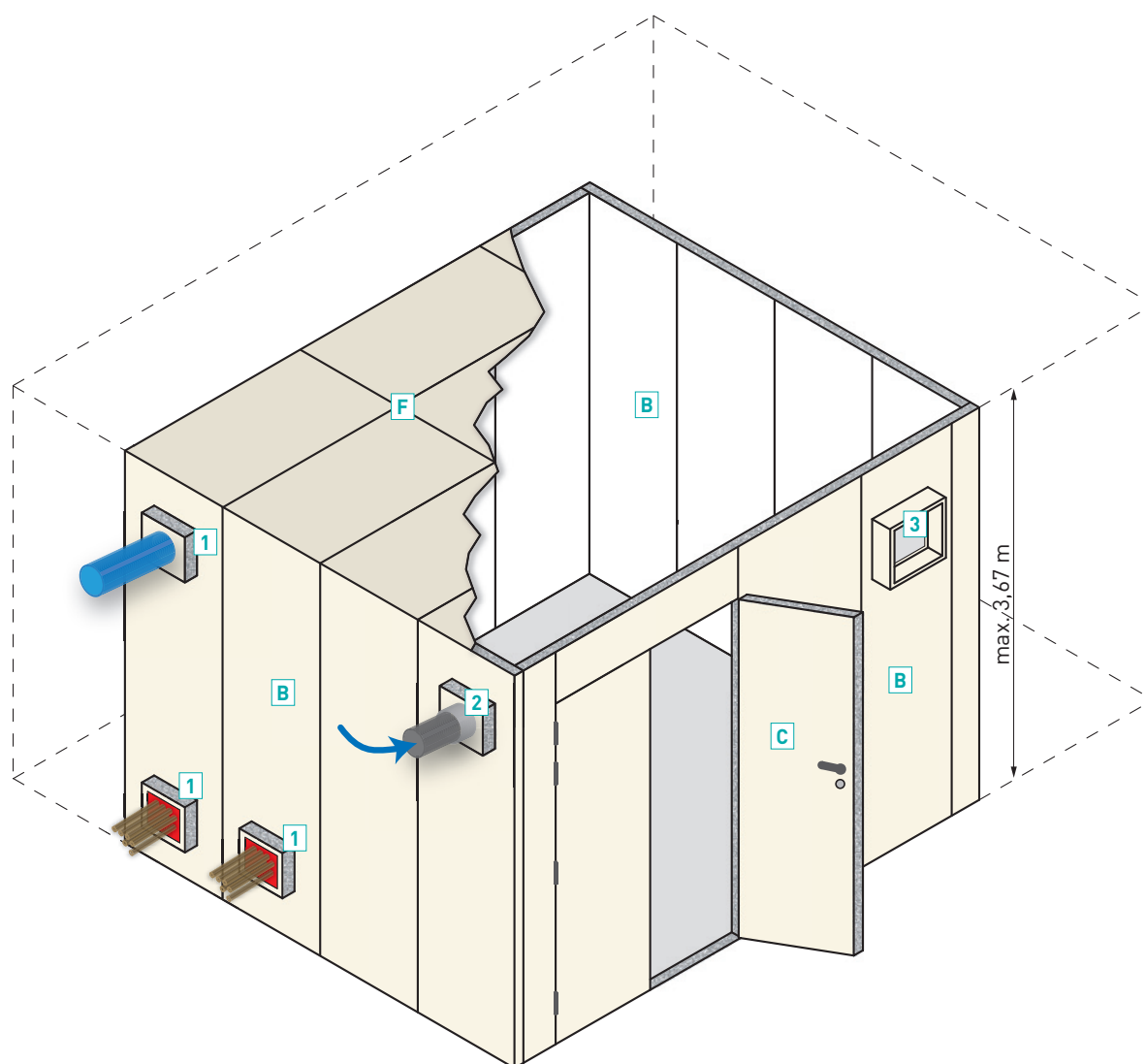

SYSTEM 42 Components

- B** Wall system PRIOWALL
- C** Fire Resisting Closure PRIODOOR FSA
- F** Ceiling system PRIOCEIL

Accessoires

- 1** Cable and pipe bulk head for wall
- 2** Ventilation flap
- 3** Fire damper

PRIOROOM is offered on a project-by-project basis

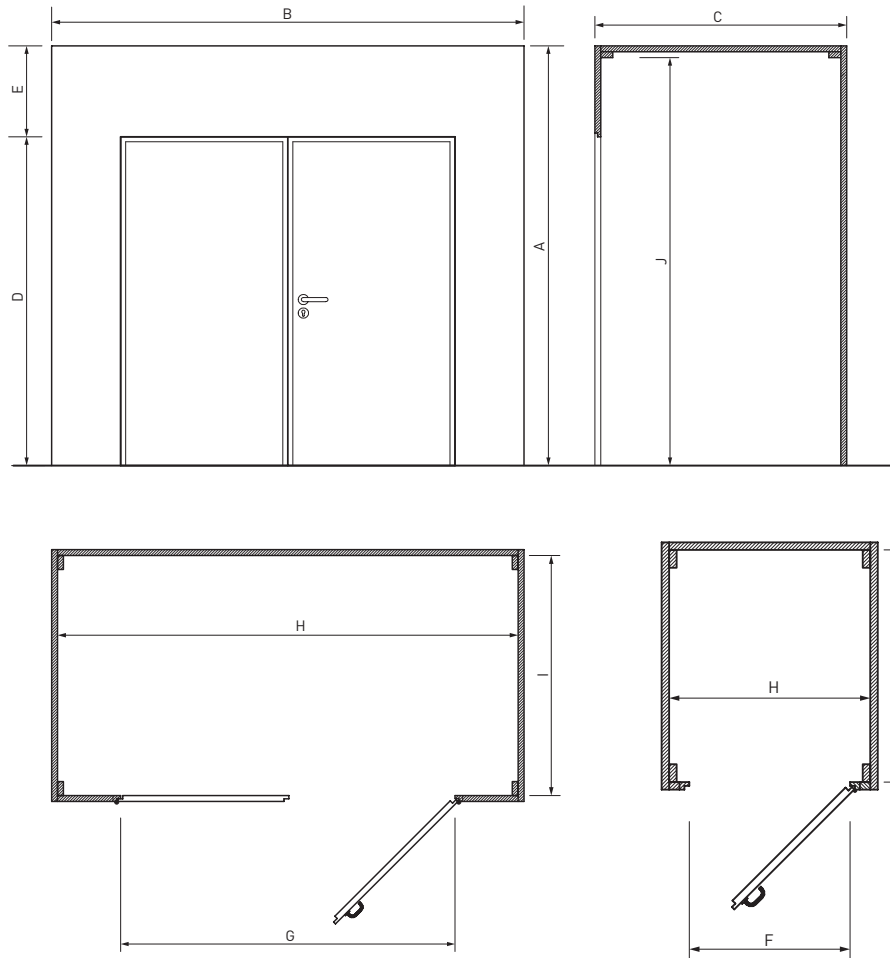

POS	Designation	Dimensions Min. / Max. mm	Your dimensions mm
A	PRIOROOM high	According to statics ≤ 3670	
B	PRIOROOM width	≤ 6500	
C	PRIOROOM depth	∞	
D	Door clearance height	≤ 2500	
E	Frame height above door	1-leaf: 250 mm 2-leaf: 500 mm	
F	Door clearance width (single-leaf door)	≤ 1250	
G	Door clearance width (double-leaf door)	≤ 2500	
H	Length internal	≤ B - 170	
I	Depth internal	≤ C - 85	
J	Effective internal height	≤ A - 45	

Options and accessories

- All PRIORIT-surfaces, see pages 48
- Single leaf, double leaf doors can be positioned freely
- Door hold-open device
- Smoke detector



■ Smoke detector



■ Doors/walls in special decor

Art.	Accessories
Artificial ventilation	
TTW-LL-K90	BEK EI90S shut-off DN 100 triggered by thermal detectors, ready for installation for SYSTEM42 constructions, with a connecting sleeve on one side for DN 100
Cable and pipe bulkhead	
KRS125	Cable and pipe bulkhead inside ø = 135 mm; Outside dimensions: 200 x 200 mm

- Doors see page 174ff
- Door accessories see page 178ff



