

Installation and Operating Instructions

RTX

Inspection opening closure

Dear Customer,

-

You have opted for a high-quality PRIORIT product.

Thank you.

Please follow the following operating instructions carefully so that we can guarantee perfect functioning of the whole system.

We cannot provide any guarantee if you fail to comply with the instructions.

We expressly reserve the right to make technical changes, even without separate announcement, which serve to improve our product, or which are caused by changes in legislation.

These operating/installation instructions may not be reprinted or reproduced – even as excerpts – without the written consent of PRIORIT AG.

PRIORIT AG

D-63457 Hanau

Tel.: +49 6181 3640-0, Fax: +49 6181 3640-210,

Email : info@priorit.de , www.priorit.de

Contents

Contents	3
Important information	4
Allowable installation	5
About these instructions	5
Transport	5
Basics	5
General safety instructions	6
Intended use	6
Functional test, safety check, care and maintenance	6
Material/surface	7
Warranty, handover certificate	7
Industrial property rights	7
Installation / scope of supply – basics	8
Assembly instructions	9
Assembling the frame	9
Screw connection of stop plate RTX 90 1-leaf	10
2-leaf version: Attaching the batting strip	10
Installation of the frame	11
Installation with steel mounting plate	12
Installation details in different types of walls	13
Installation details in different types of walls	14
Installation details in different wall types as surface mounting	15
Installation of the door leaf or door leaves	16
Removal and installation of the profile cylinder	17
Layout of the UA section	18
RTX30 built-in installation (flush mounting)	19
In solid wall	19
In shaft wall	19
In PRIOWALL	19
On clad steel member	20
On clad steel member	20
RTX90 built-in installation (flush mounting)	21
In solid wall	21
In shaft wall	21
In PRIOWALL	21
On clad steel member	22
On clad steel member	22
Surface mounting RTX90	23
On solid wall	23
On shaft wall on both sides	23
On installation shaft planked on one side	23

On clad steel component.....	24
On PRIOWALL	24
Declaration of conformity RTX30.....	25
Declaration of conformity RTX90.....	26

Important information



The product must be installed and assembled plumb and horizontal!



When putting down the product, do not load the corners and lay soft material on the storage area first, e.g. transit blanket!

Allowable installation

- See verifications of fitness for use

About these instructions

- These instructions are not a manufacturer's declaration or a regulatory verification of fitness for use.
- The information in these instructions applies to a large number of products.
- For binding technical and approval information, please refer only to the regulatory verifications of fitness for use (for example, national technical approval), the manufacturer declarations submitted by the installing contractor and our order confirmation which, on being signed by our contractual partner, becomes part of the purchase agreement.

Transport

- If the packaging is damaged, the carrier must be informed in writing of the damage by noting it on the delivery note – simply acknowledging receipt to the delivering carrier excludes any recognition of transport damage. The same applies to missing packages according to the delivery note.
- The pallet must be lifted from the narrow side with forks passing completely through to the end of the pallet.
- Attention: approx- 70 kg/m² area incl. frame. Attention: Risk of injury!
- Attention: The product can be damaged if pointed or sharp objects such as knives are used to open the packaging.

Basics

- These installation instructions do not replace basic knowledge and skills regarding the installation of doors in general and inspection opening closures in particular.
- The inspection opening closures should only be installed by qualified, skilled personnel to ensure correct installation and the required quality of installation.
- Do not install any damaged parts – the warranty and verification of fitness for use expire immediately.
- The product does not achieve the necessary regulatory verification of fitness for use unless it is installed completely and properly.
- Buildings laws, directives and regulations, and the instructions of the competent building control office and the responsible fire safety expert engaged must be followed.
- As the installer, do not issue an unconditional manufacturer's declaration of compliance with the regulatory technical approval unless the product installation is compliant and all necessary hardware has been mounted. Note on it any necessary deviations, which are not minor.

General safety instructions

- The operating / installation instructions must be kept in the place in which the product is used at all times..
- Legally stipulated safety instructions must be attached in a place visible to the users.
- All safety instructions and hazard warnings and the nameplate must be kept in a legible condition.
- Use the product only if it is in proper condition.
- Note the technical details of the respective product given in our catalogue or data sheet.
- Improper installation can impair the protective function.
- Follow all information and instructions in these operating and maintenance instructions.
- An exhaustive list of all relevant regulations, guidelines and directive would go beyond the scope of this document. You must therefore check that your facility conforms to the relevant regulations.

Intended use

- The product described in these operating / installation instructions is built to state-of-the-art standards and the recognised rules of safe practice.
- It may only:
 - be used for its intended purpose and
 - only in a perfect, safe condition.
- Any other use is deemed not to be as intended and is therefore misuse. PRIORIT is not liable for the resulting damage and any consequential damage.

Functional test, safety check, care and maintenance

- Service/maintain the product at least 1x yearly and check for fault-free function.
We recommend that you perform a functional check (visual inspection) once a month.
The safety check can only be performed with the necessary care by a qualified employee, as adequate experience and comprehensive level of knowledge are indispensable.
- Standard, mild household cleaners can be used to clean the outside of the product.
- The product must be protected against water, penetrating moisture and spray water.
- If safety-relevant damage is found, it must be repaired using original parts before further use.
- The following points must be noted in the service or maintenance:
 - Closing and lock fault-free
 - Hinges and fixing points are undamaged.
 - Rubber seal, fire protection seals are undamaged.
 - Proper, faultless movement of the door leaves.
 - Hinges and locks oiled and/or greased.
 - Full functionality.

Material/surface

- Construction material incl. surface coating A2-s1, dO: non-combustible.
- Construction material, incl. surface with high chemical resistance, mechanical strength and stability.

Warranty, handover certificate

To ensure our products function optimally, the installation instructions must always be followed.

The PRIORIT warranty covers the delivered products.

Changes or alterations to the design or construction may only be made following consultation with PRIORIT, as otherwise the approval/warranty expires.

The warranty for installation work must be provided by the installer.

Warranty and liability claims for personal injuries and damage to property are excluded, if they are due to one or several of the following causes:

- The product is not used as intended.
- Improper installation, commissioning, operation and maintenance.
- Disregard of the instructions regarding transport, storage, operation and installation.
- Unauthorised structural changes to the product.
- Improper repairs.
- Disasters due to third party interference or force majeure.

Industrial property rights

Utility model specifications have been registered with the German Patent Office to safeguard innovation and design.

Installation / scope of supply – basics

- Our inspection opening closures can be implemented in many different solutions and installation forms. Fixing sets must be ordered separately or put together yourself in accordance with these operating instructions.
- Our doors are delivered with profile (Euro) cylinders as a standard fitting.
- Follow the accident prevention and workplace guidelines.
- Comply with the respective national or state building code regarding the evaluation of fire protection and structural aspects.
- Use the products only if they are in a proper condition.
- We cannot accept any liability for damage and malfunctions caused by improper transport or installation.
- The swivel and closing area of the doors must be kept clear at all times.
- Improper installation can impair the protective function.
- Threaded fastenings on/in the structure may only be made using approved, suitable screws/anchor plugs.
- The suitability of the screws/anchor plugs must be checked on a case-by-case basis depending on the structure.
- Fixing materials required must be matched to the structure and the corresponding load and, if necessary, must be supplemented. Any fixing material supplied with the product only corresponds to part of the needs.

1-piece frame:

- When unpacking, first remove the frame from the pallet.
- To do this, lift the frame vertically upwards with at least 2 people.
- Pins for the straps are included in the accessory pack.

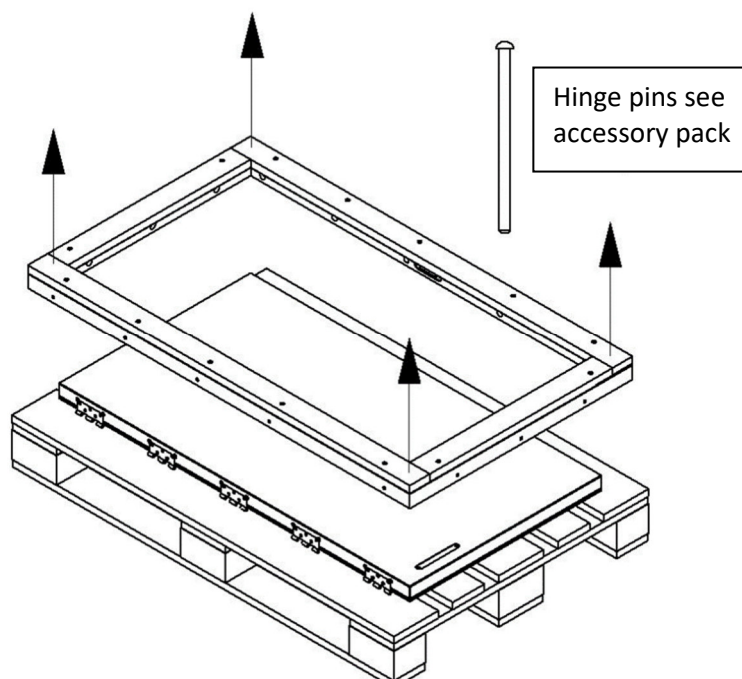

Assembly instructions



The product must be installed and assembled plumb and horizontal!

Assembling the frame

1. Assembly is not necessary for a 1-piece frame.
2. The following steps are necessary for 2-piece frames:
 - Position in the wall opening
 - Screw the frame parts together with connecting lockplates, see Fig.
3. The following steps are necessary for 4-piece frames:
 - The frame should be assembled flat!
 - The component parts are: 2 upright and two transverse frame parts
 - Use the enclosed panhead screws 6x120mm and plain washers to screw together the upright and transverse frame parts. The holes required for this are already made in the frame parts.
 - 2 panhead screws and 2 plain washers are used for each corner joint.
 - If the frame is installed flush in the wall opening, the steel mounting plate for fixing the frame must also be used.

See heading: "Installation with steel mounting plate".



Panhead screw 6x120mm



Plain washer M7

Connecting lockplate detail
for 2-piece frame

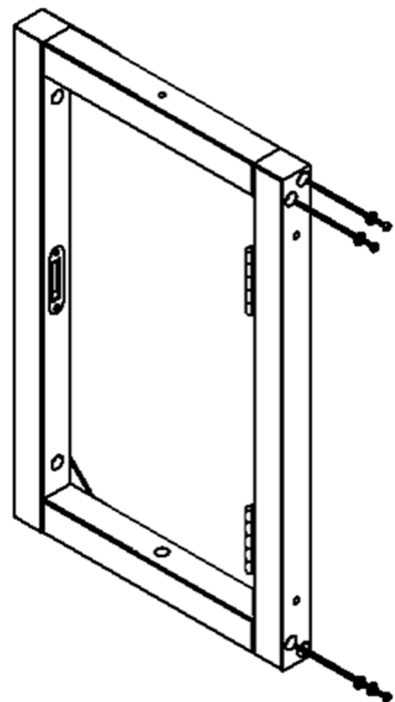
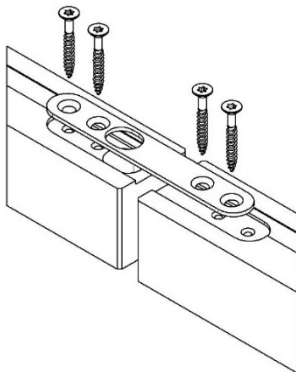

Screw connection of stop plate RTX 90 1-leaf

- Dismantle the transverse and lock-side doublings.
- Screw stop plate top/bottom with 2nd countersunk screw.
- Reassemble the double stops.
- Or, if available, screw through borehole.

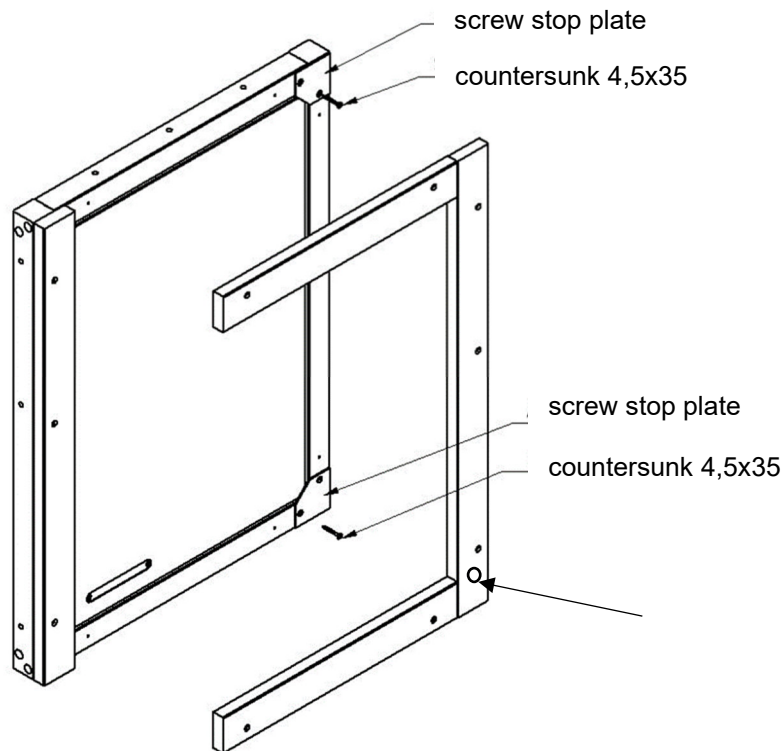

2-leaf version: Attaching the batting strip

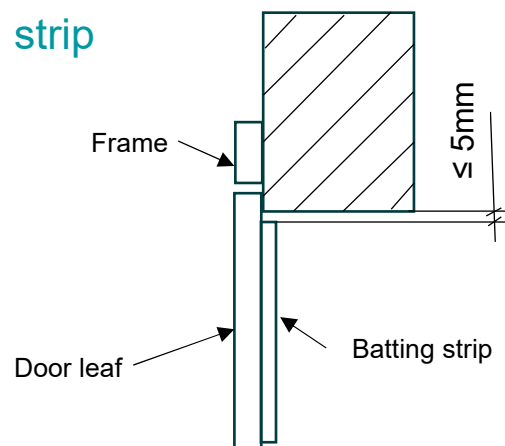
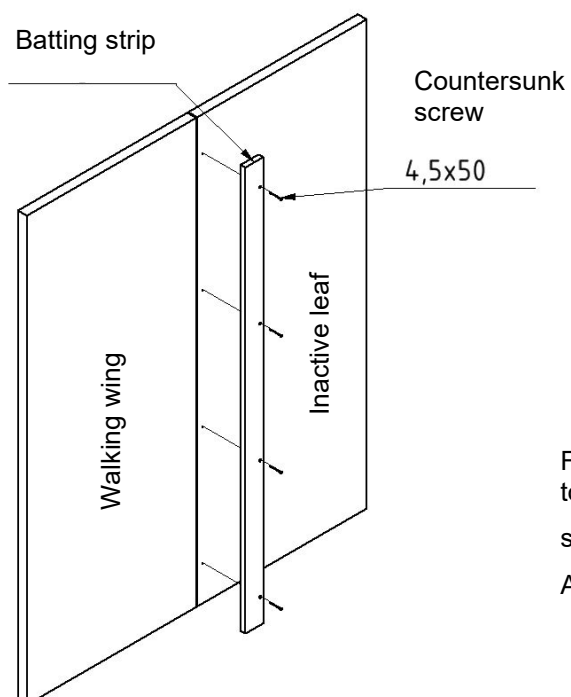

For surface-mounted installation, batting stripe top/bottom

shorten individually.

Applies to installation without doublings.

Installation of the frame

- Align the frame plumb and horizontally.
- Ensure that the frame is not exposed to any loads during or after installation, caused by installation not square or over-tightened screws without counter-bearing (warping of the frame). **Risk of breakage!**
- Use the appropriate fixing material for the support structure (masonry, concrete, studwork, Priodek H) to fix the frame.
- **Always place the underlay material under the upright frame parts!**
- **Always install plumb and horizontal!**

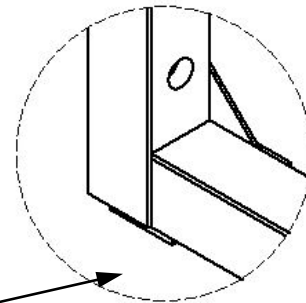

Underlay material! Noncombustible!

For the installation of the product, we recommend our underlay blocks made of non-combustible PRIODEK H. Available in our range.

Installation with steel mounting plate

In case of frame width > 43mm, countersunk head screws 4.5x35mm are used as the threaded fasteners.

Holes with Ø 3.5mm must be pre-drilled!

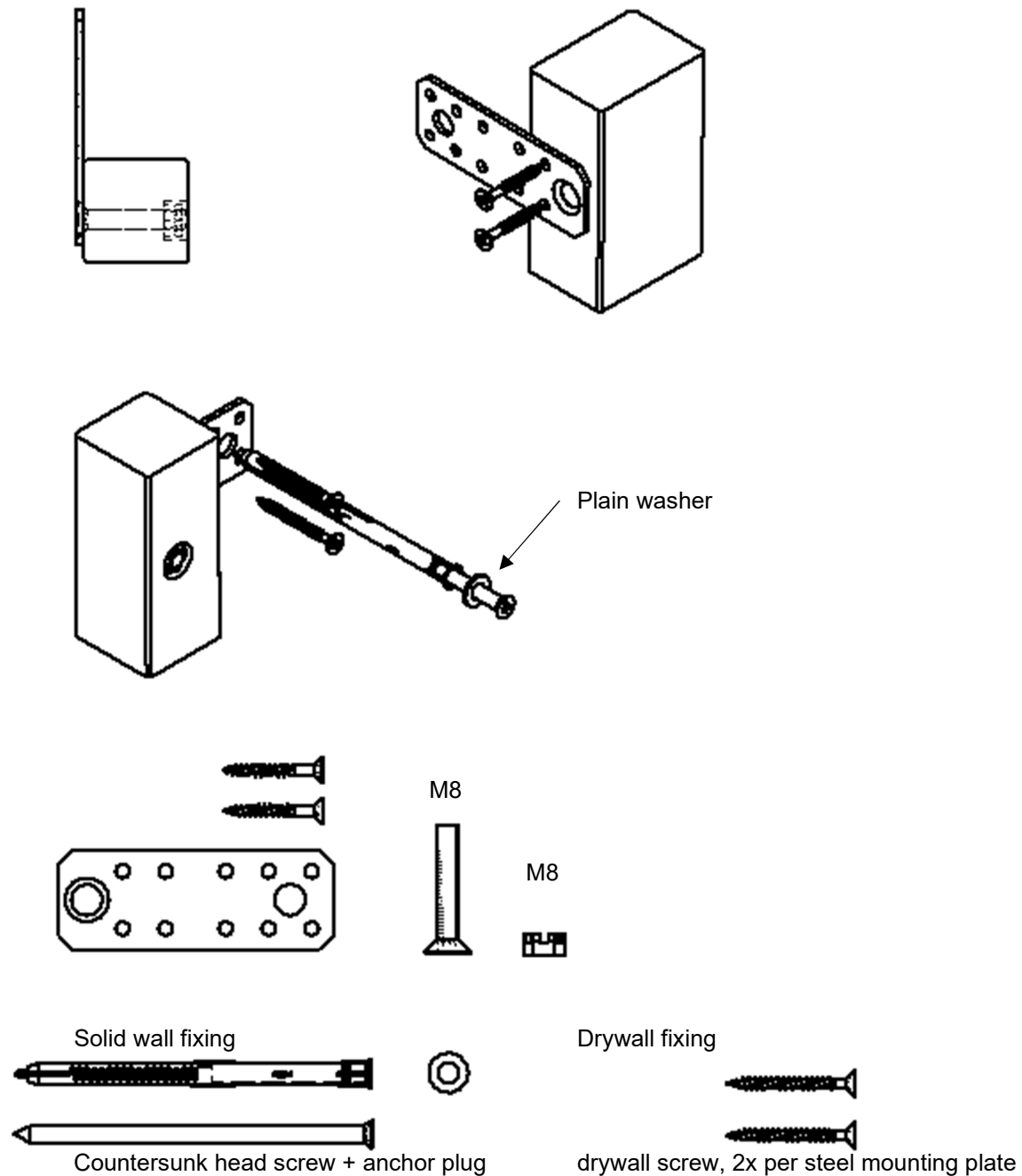

Installation details in different types of walls

Drywall installation

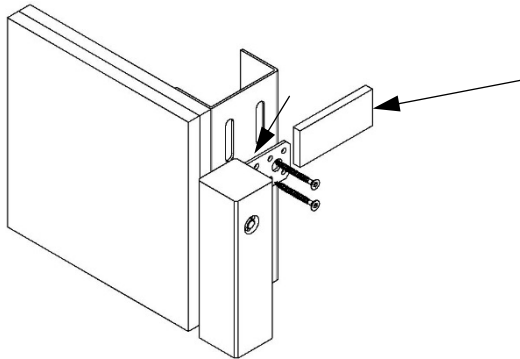

Noncombustible underlay material, on site
Not included in the scope of supply!

Installation in solid wall (flush with the surface)

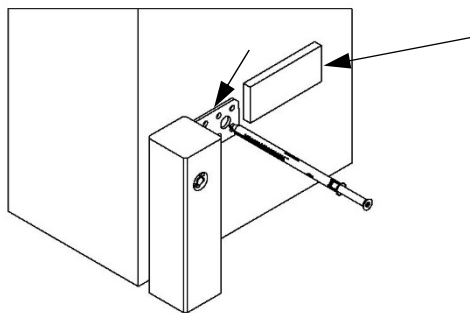

Noncombustible underlay material, on site
Not included in the scope of supply!

Installation in solid wall (flush)

Steel mounting plate tilted for thin walls!

Also applies to installation in drywalls with low wall thicknesses!

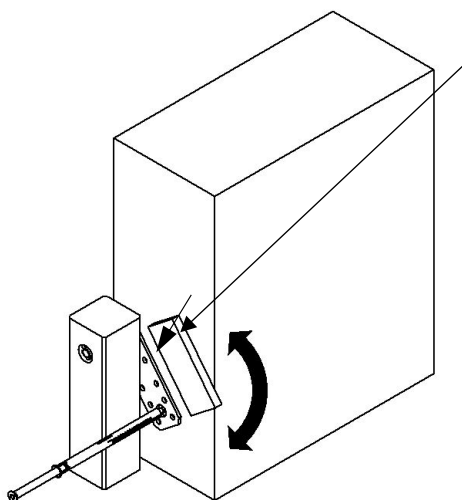

Noncombustible underlay material, on site
Not included in the scope of supply!



Always install plumb and horizontal!

Installation details in different types of walls

Installation in solid wall (centrally in the reveal)

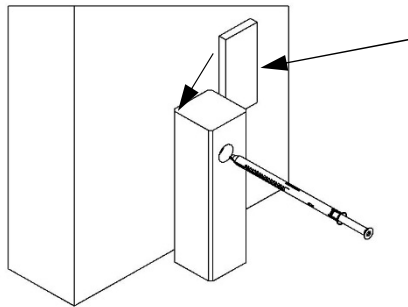

Noncombustible underlay material, on site
Not included in the scope of supply!

Installation in PRIOWALL

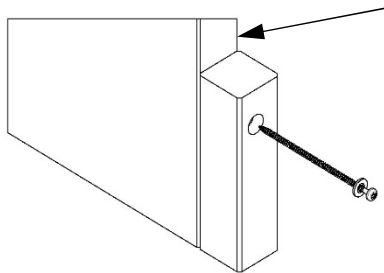

Pre-drilling in PRIOWALL 1mm smaller than screw diameter.
Depth of the pre-drilling 2 mm deeper than the thread
engagement length of the screw.



Always install plumb and horizontal!

Installation details in different wall types as surface mounting

Installation in drywall

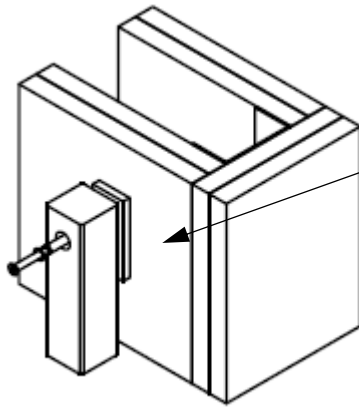

non-flammable underlay material, on site
Not included in delivery

Installation in solid wall

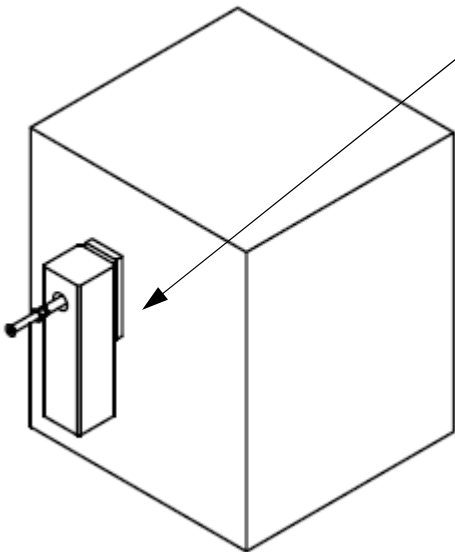

non-flammable underlay material, on site
Not included in delivery

Installation in PRIOWALL

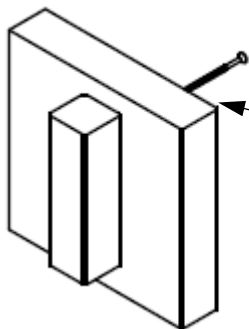

Pre-drilling in PRIOWALL 1 mm smaller than screw diameter.
Depth of pilot hole 2 mm deeper than screw-in depth of screw.



Always install flush and level!

Installation of the door leaf or door leaves

Door hinge

- Hang, unhang and align the door leaf or door leaves.

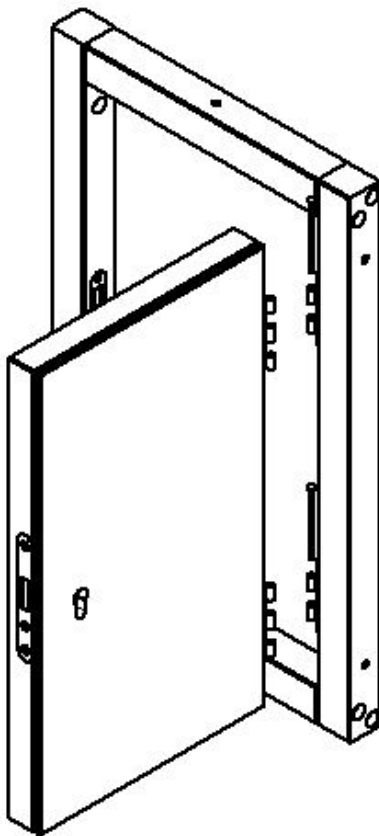

Hang and unhang the door leaf only by inserting or removing the hinge pins

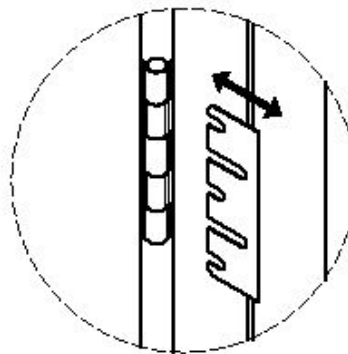

or remove spacer plates on the leaf side only! Insert

The clearance can be adjusted by inserting or removing spacer plates.

The adjustments must only be made on the door leaf.

To do this, support the weight of the door leaf and then undo slightly the threaded fastener of a hinge on the door leaf. You can now insert or remove a spacer plate; then retighten the threaded fasteners of the hinge. Repeat in the same way for the other hinges if necessary.

Removal and installation of the profile cylinder

Necessary tools:

Screwdriver and key for the profile cylinder.

If a key is no longer available, the cylinder must be drilled out.

1. Removing the profile cylinder

The profile cylinder is held in place by a forend screw which is located in the forend of the lock at the height of the profile cylinder. Loosen the forend screw with a screwdriver and pull it out.

Insert the key into the profile cylinder and turn it to the right or left. Pull the key slightly while doing so. If the locking lug of the cylinder is in the correct position, the profile cylinder can be pulled out.

If the profile cylinder is stuck, loosen it by gently jiggling the profile cylinder.

If the profile cylinder is stuck, in most cases it is jammed on the lock: loosen (do not remove) the fastening screws of the forend and take out the lock cylinder.

2. Installing the profile cylinder

Insert the profile cylinder, turning the key to the left or right until the locking lug is in the correct position. Then tighten with the forend screw.

If the profile cylinder cannot be inserted, try to find the position of the opening in the lock by gently jiggling the profile cylinder.

If it still cannot be inserted, loosen (but do not remove) the forend fixing screws and insert the locking cylinder. Then retighten the fixing screws of the forend.

Layout of the UA section

for installation in shaft wall

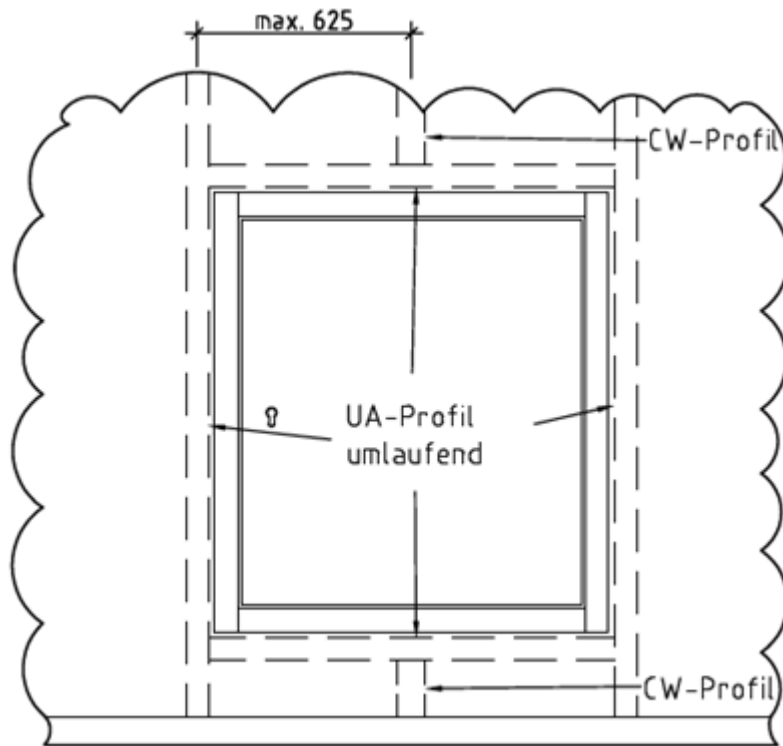

RTX30 built-in installation (flush mounting)

In solid wall

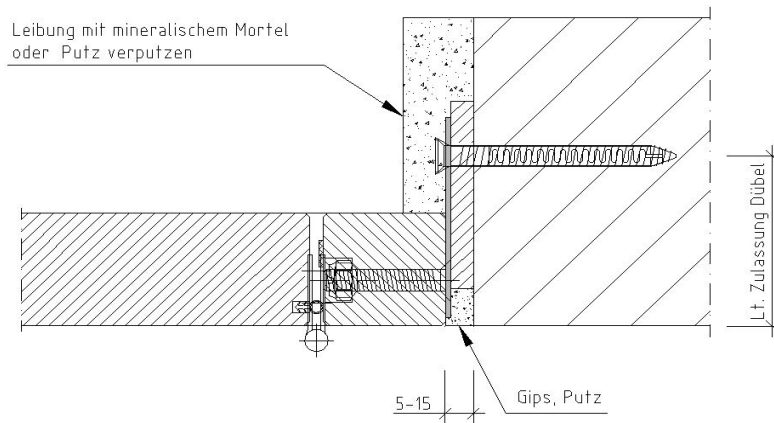

In shaft wall

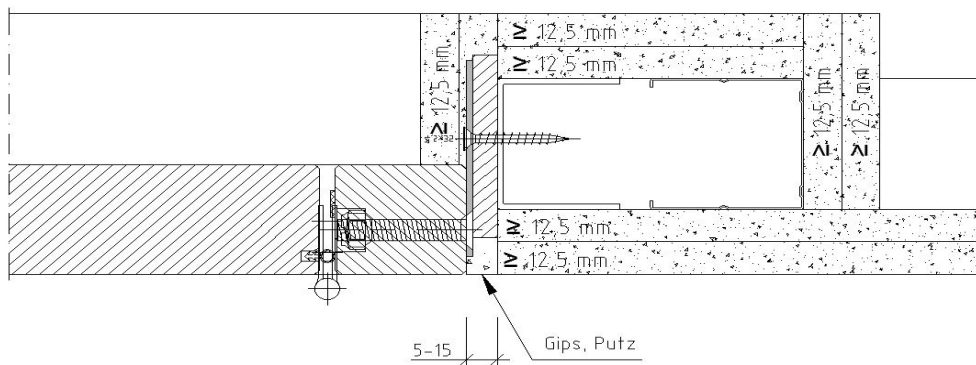

In PRIOWALL

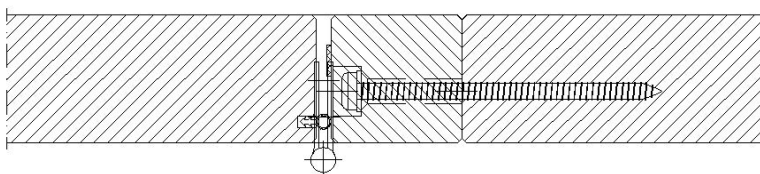

On clad steel member

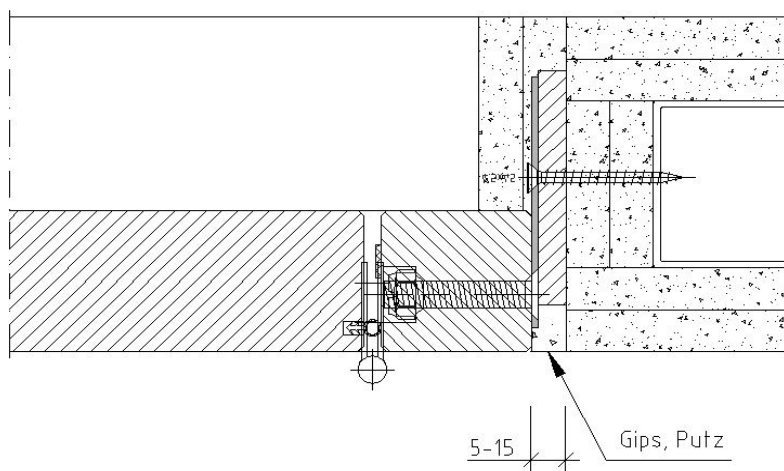

On clad steel member

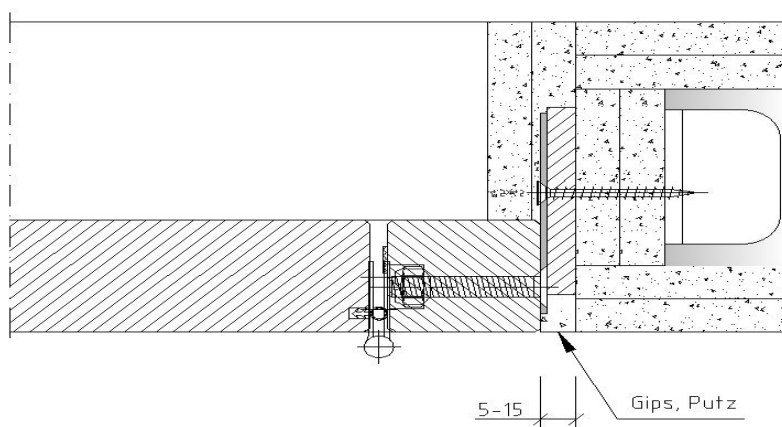

RTX90 built-in installation (flush mounting)

In solid wall

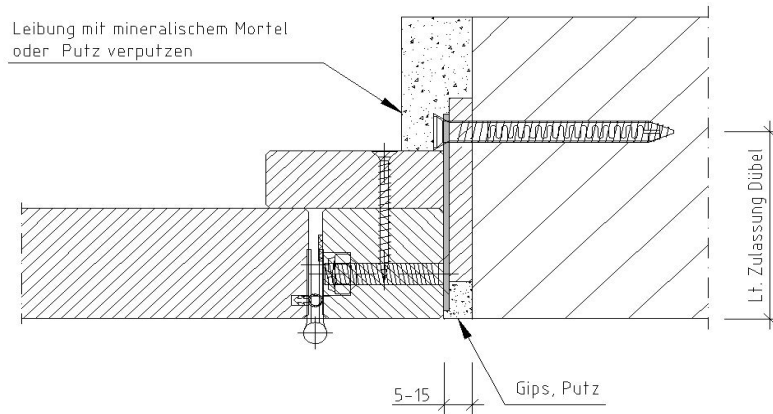

In shaft wall

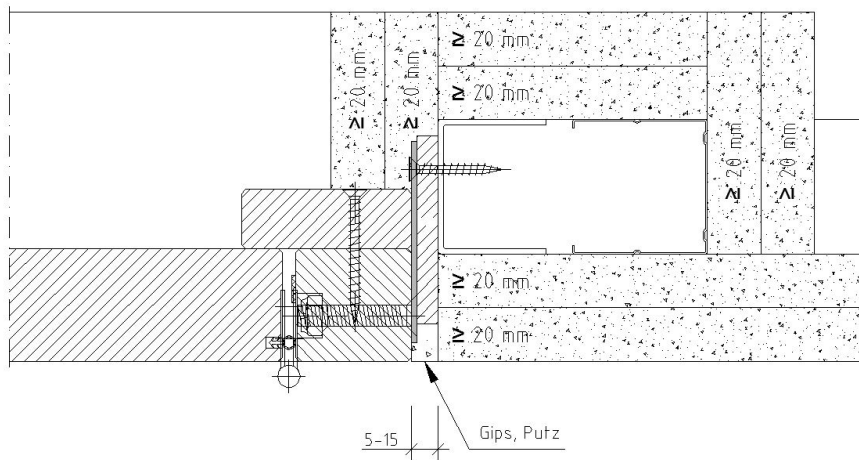

In PRIOWALL

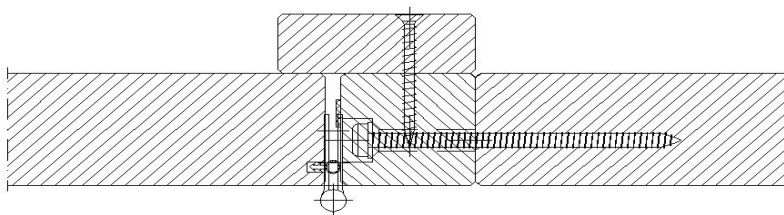

On clad steel member

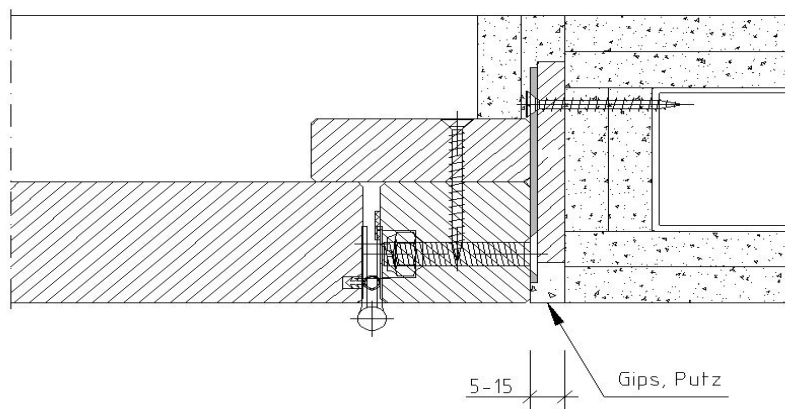

On clad steel member

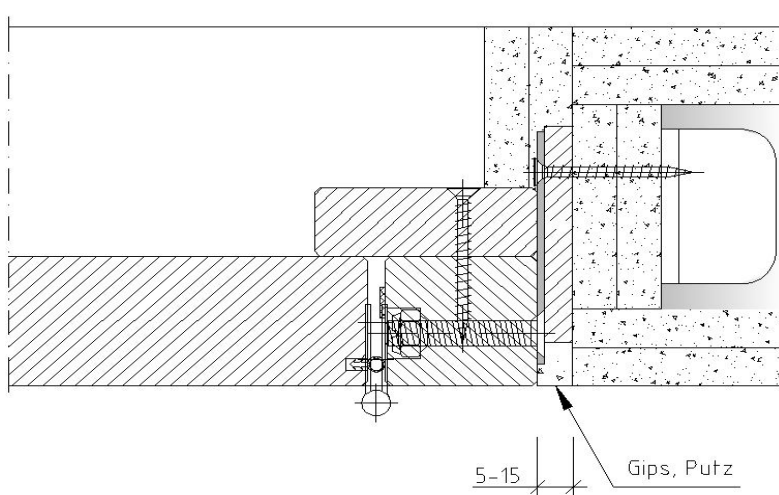

Surface mounting RTX90

On solid wall

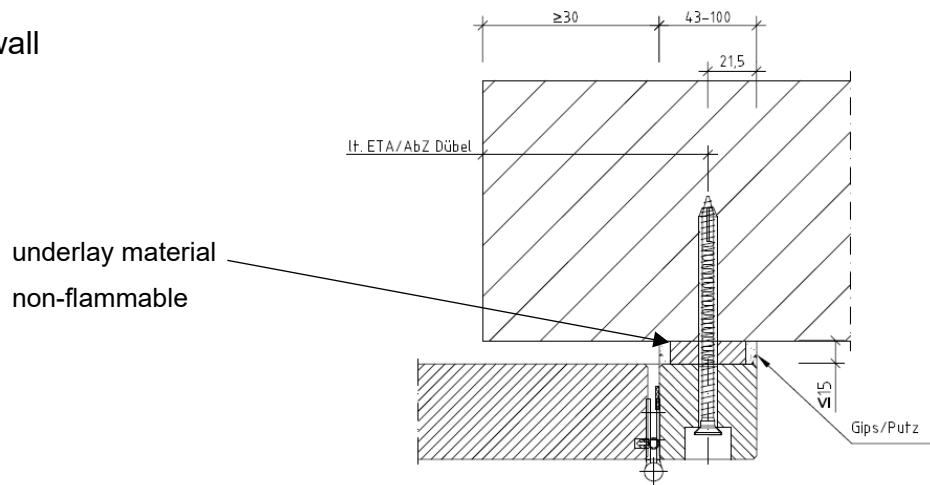

On shaft wall on both sides

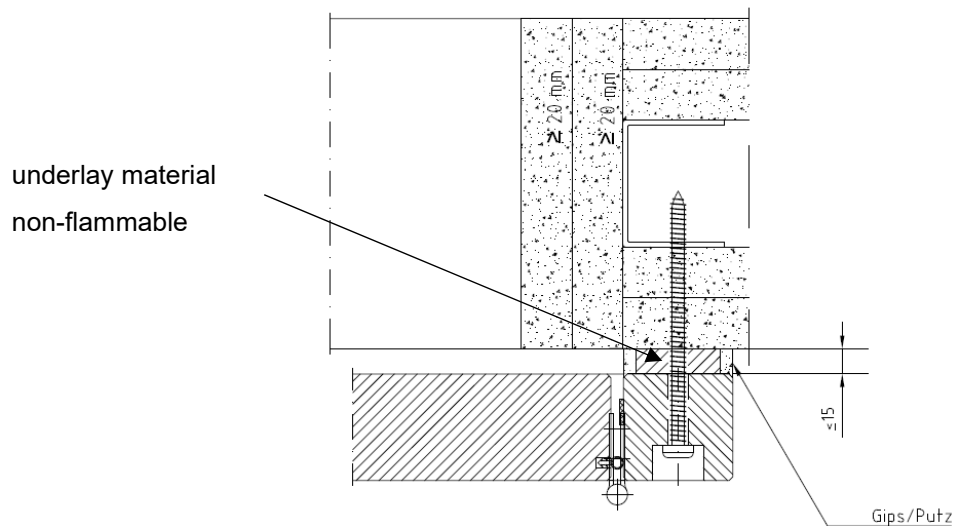

On installation shaft planked on one side

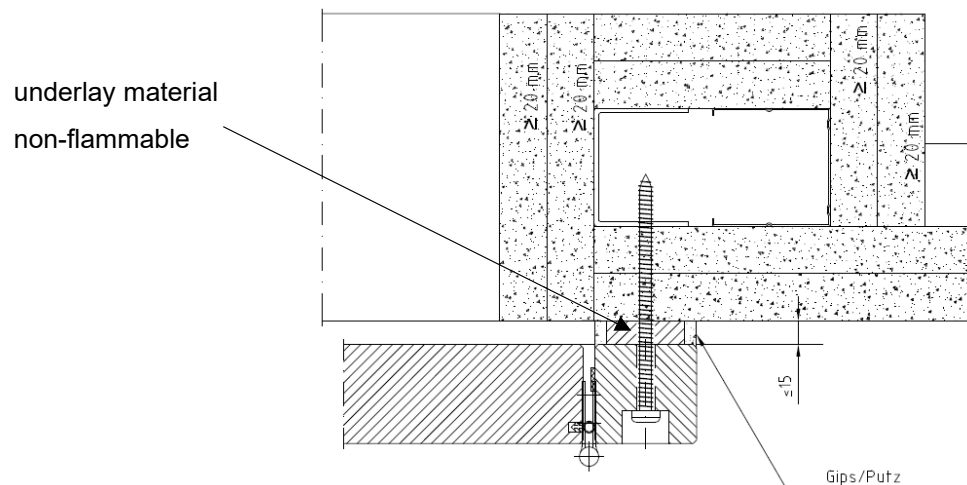

On clad steel component

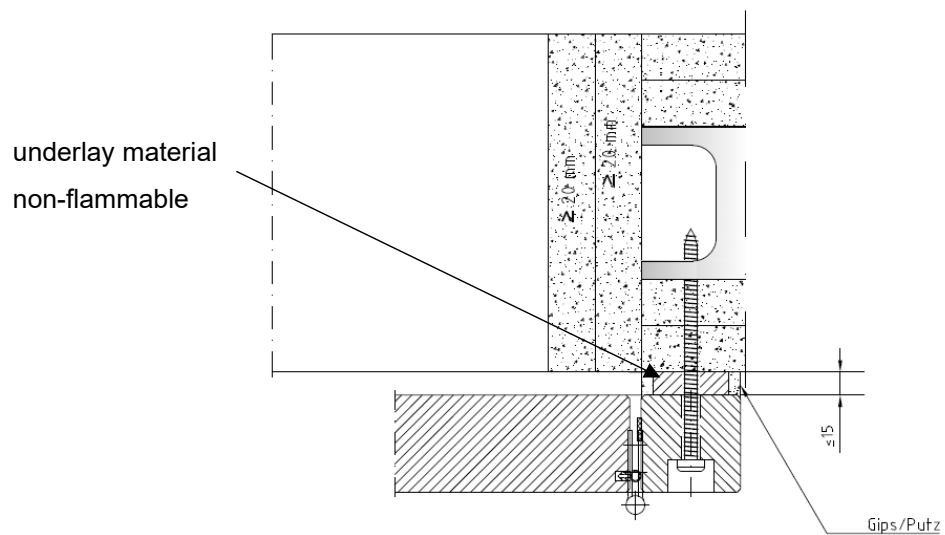
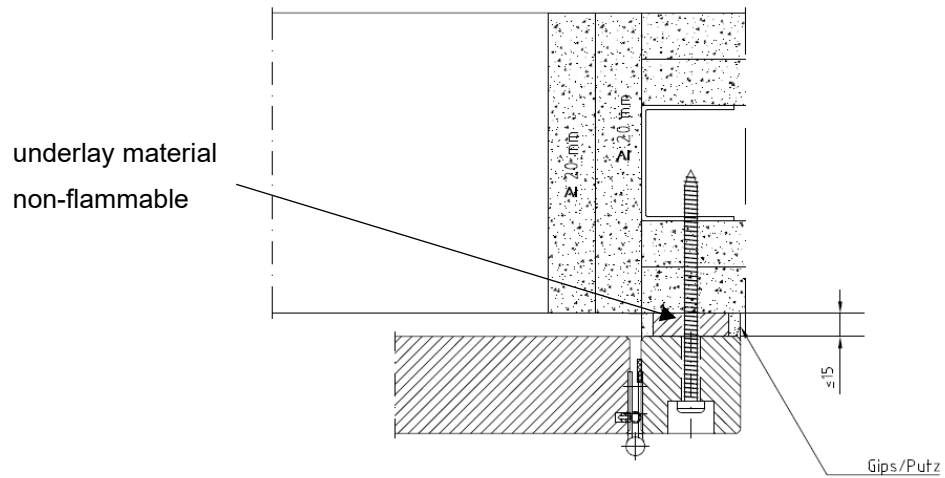

On PRIOWALL

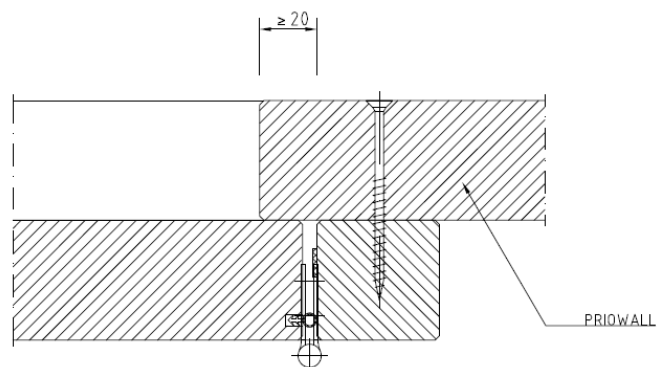

Declaration of conformity RTX30

Übereinstimmungserklärung

- Name und Anschrift des Unternehmers, das den **Revisionsöffnungsverschluss**/ die **Revisionsöffnungsverschlüsse** eingebaut hat:

- Bauvorhaben:

- Zeitraum des Einbaus
des Revisionsöffnungsverschlusses/der Revisionsöffnungsverschlüsse:

Hiermit wird bestätigt, dass der **Zulassungsgegenstand**/die **Zulassungsgegenstände** hinsichtlich aller Einzelheiten fachgerecht und unter Einhaltung aller Bestimmungen der allgemeinen bauaufsichtlichen Zulassung Nr.: Z-6.55-2453 des Deutschen Instituts für Bautechnik sowie der Einbauanleitung, die der Antragsteller dieser Zulassung bereitgestellt hat, eingebaut wurde.

Ort, Datum

Firma/Unterschrift

(Diese Bescheinigung ist dem Bauherrn zur ggf. erforderlichen Weitergabe an die zuständige Bauaufsichtsbehörde auszuhändigen.)

EP.A.10836-1

Declaration of conformity RTX90

Übereinstimmungserklärung

- Name und Anschrift des Unternehmers, das den **Revisionsöffnungsverschluss/ die Revisionsöffnungsverschlüsse** eingebaut hat:

- Bauvorhaben:

- Zeitraum des Einbaus
des Revisionsöffnungsverschlusses/der Revisionsöffnungsverschlüsse:

Hiermit wird bestätigt, dass der **Zulassungsgegenstand/die Zulassungsgegenstände** hinsichtlich aller Einzelheiten fachgerecht und unter Einhaltung aller Bestimmungen der allgemeinen bauaufsichtlichen Zulassung Nr.: Z-6.55-2445 des Deutschen Instituts für Bautechnik sowie der Einbauanleitung, die der Antragsteller dieser Zulassung bereitgestellt hat, eingebaut wurde.

Ort, Datum

Firma/Unterschrift

(Diese Bescheinigung ist dem Bauherrn zur ggf. erforderlichen Weitergabe an die zuständige Bauaufsichtsbehörde auszuhändigen.)

EP.A.10837-1